

SIRUBA®

銀箭牌工業用縫紉機
INDUSTRIAL SEWING MACHINE

FA007

PARTS LIST

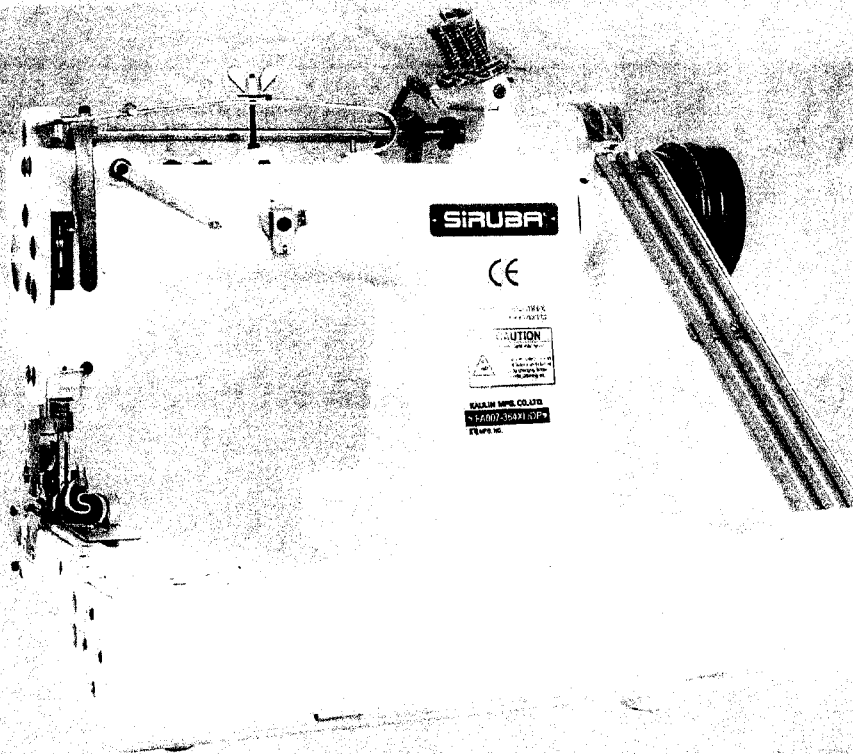

CE



高林股份有限公司
KAULIN MFG. CO., LTD.

CONTENTS

1. C0- MACHINE BODY
2. C1- UPPER SHAFT MACHANISM
3. C2- NEEDLE BAR MECHANISM
 - FEED MECHANISM
4. C3- PULLY MECHANISM
5. C4- PRESSER BAR MECHANISM
6. C5- LOOPER MECHANISM
7. C6- UPPER THREADING MECHANISM
8. C7- LOWER THREADING MECHANISM
9. C8- LOWER SHAFT MECHANISM
 - GAUGE PARTS
- 10.C9- GAUGE PARTS(SP)
11. C10- GAUGE PARTS(DP)
12. C11- PULLER DEVICE MECHANISM
13. C12- ACCESSORIES

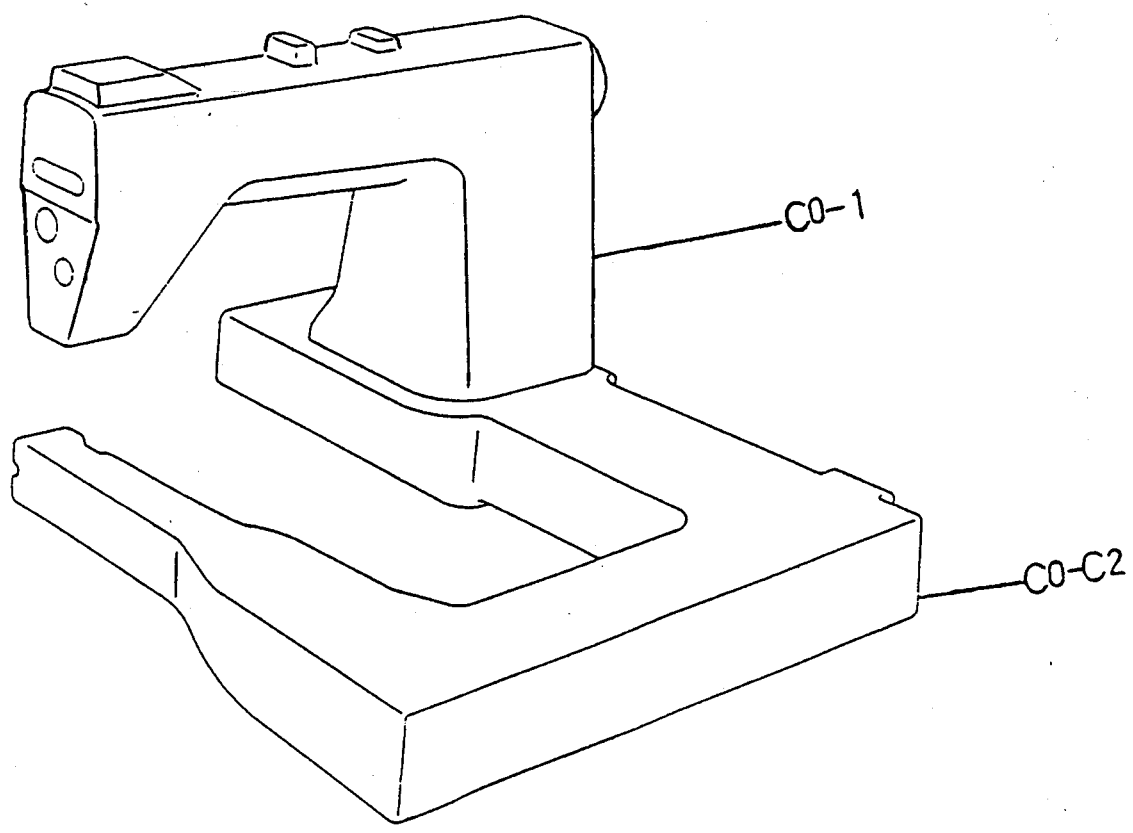
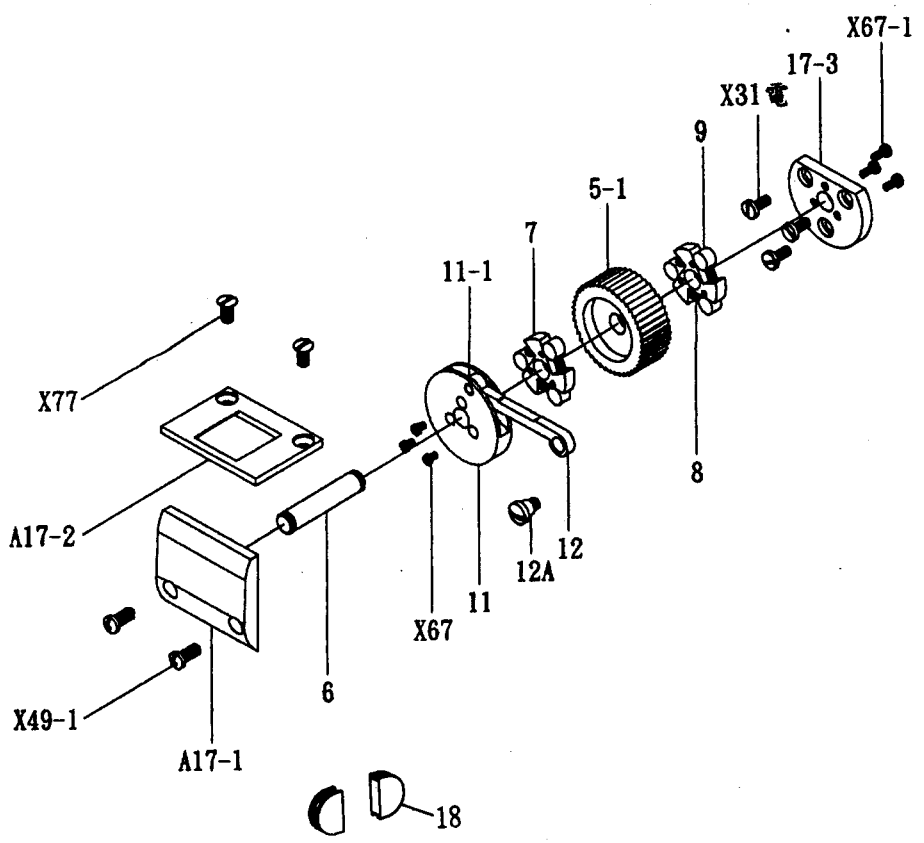

C0

REF. NO.	NAME OF PARTS
C 0 - 1	MACHINE HEAD
C 0 - C 2	MACHINE REST BOARD
C 0 - 5-1	LOWER WHEEL
C 0 - 6	LOWER WHEEL CONNECTION
C 0 - 7	ONE WAY TRIANGULAR AXLE
C 0 - 8	ONE WAY STILL SPRING
C 0 - 9	ONE WAY STILL BALL
C 0 - 1 1	ONE WAY PUSHING PLATE
C 0 - 1 1-1	PIN
C 0 - 1 2	FEED DOG PUSHING PLATE LINK
C 0 - 1 2 A	SCREW
C 0 - A17-1	PULLER COVER
C 0 - A17-2	PULLER TOP COVER
C 0 - 1 7-3	PACKING
C 0 - 1 8	PLASTIC COVER
C 0 - X31	SCREW 3.57×8
C 0 - X49-1	SCREW 3.57
C 0 - X67	SCREW 2.38
C 0 - X67-1	SCREW 2.38×6
C 0 - X77	SCREW 4.37×9

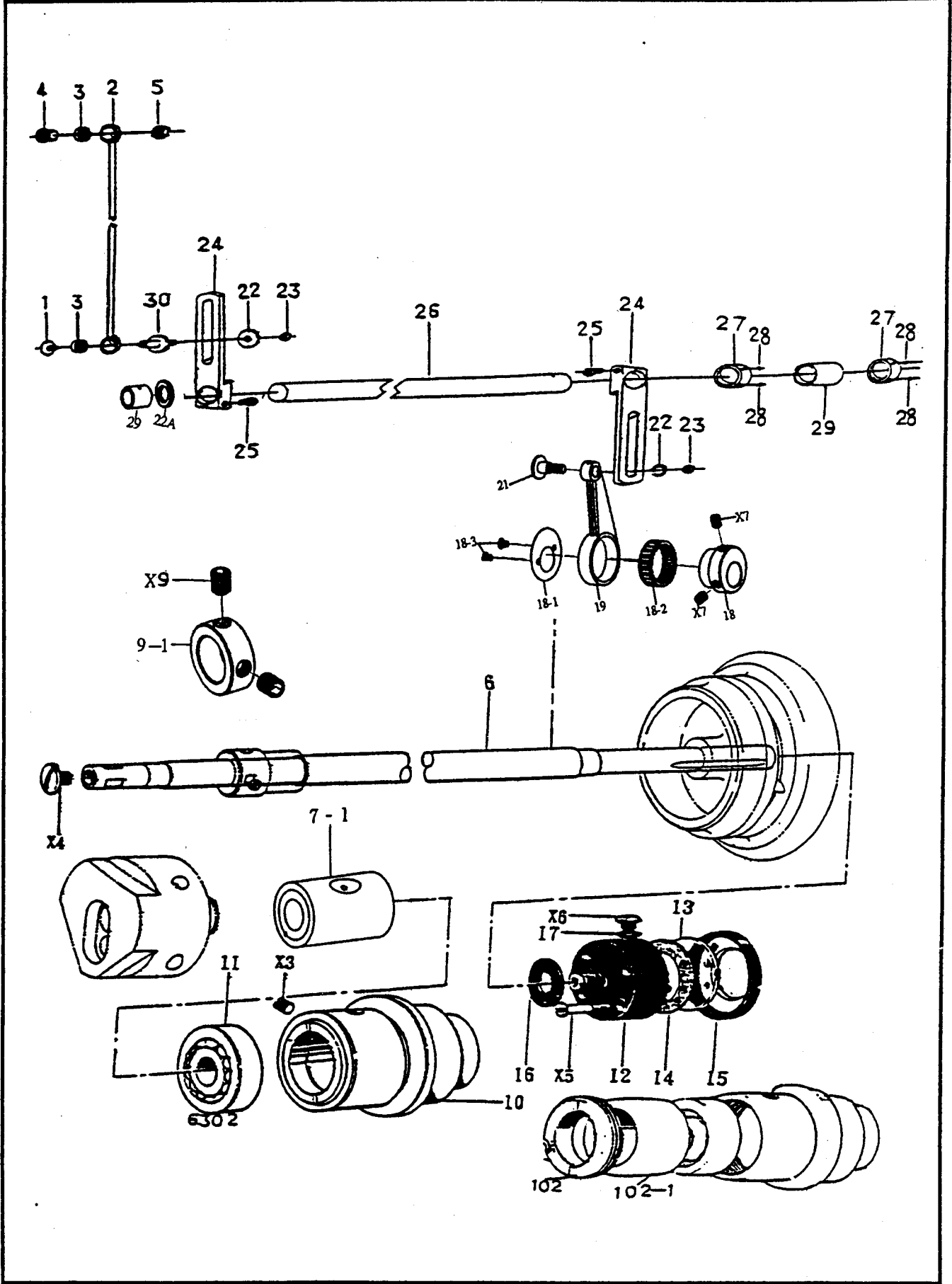

REF.NO.	NAME OF PARTS
C 1 - 1	PULL BAR ENDING SCREW
C 1 - 2	VERTICAL PULL BAR
C 1 - 3	PULL BAR BEARING
C 1 - 4	VERTICAL PULL BAR FIXING SCREW (LOWER)
C 1 - 5	PULL BAR SCREW NUT
C 1 - 6	UPPER SHAFT
C 1 - 7 - 1	FIXING BUSHING
C 1 - 9 - 1	CHOCK RING
C 1 - 1 0	BEARING CASE ASSEMBLY
C 1 - 1 1	BEARING 6302
C 1 - 1 2	OIL TANK
C 1 - 1 3	OIL GAUGE WINDOW
C 1 - 1 4	PACKING
C 1 - 1 5	OIL GAUGE FLANGE
C 1 - 1 6	OIL TANK PACKING
C 1 - 1 7	PACKING
C 1 - 1 8	UPPER WHEEL ECCENTRIC WHEEL
C 1 - 1 8- 1	ECCENTRIC WHEEL WASHER
C 1 - 1 8- 2	BEARING
C 1 - 1 8- 3	SCREW 3.57
C 1 - 1 9	UPPER WHEEL MOVING PULL BAR ("8" TYPE)
C 1 - 2 1	PULL BAR SCREW
C 1 - 2 2	FIXING PULL BAR SCREW WASHER
C 1 - 2 2A	SCREW WASHER
C 1 - 2 3	PULL BAR SCREW NUT
C 1 - 2 4	THICKNESS ADJUSTING PULL BAR
C 1 - 2 5	PULL BAR FIXING PULL BAR
C 1 - 2 6	UPPER WHEEL CONNECTION
C 1 - 2 7	MOVABLE LEFT-RIGHT CHOCK RING
C 1 - 2 8	CHOCK RING SCREW
C 1 - 2 9	CONNECTION COPPER TUBE

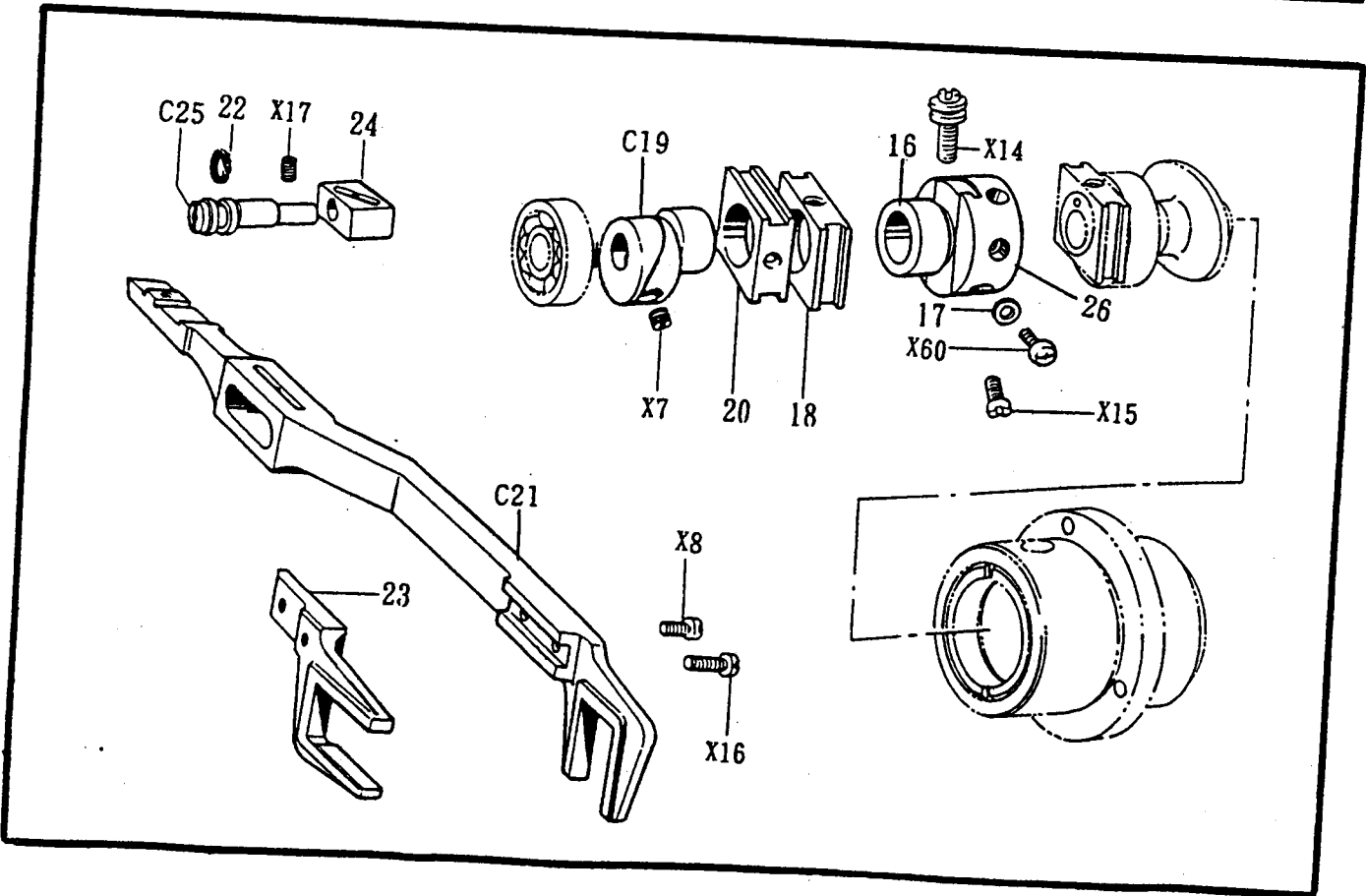
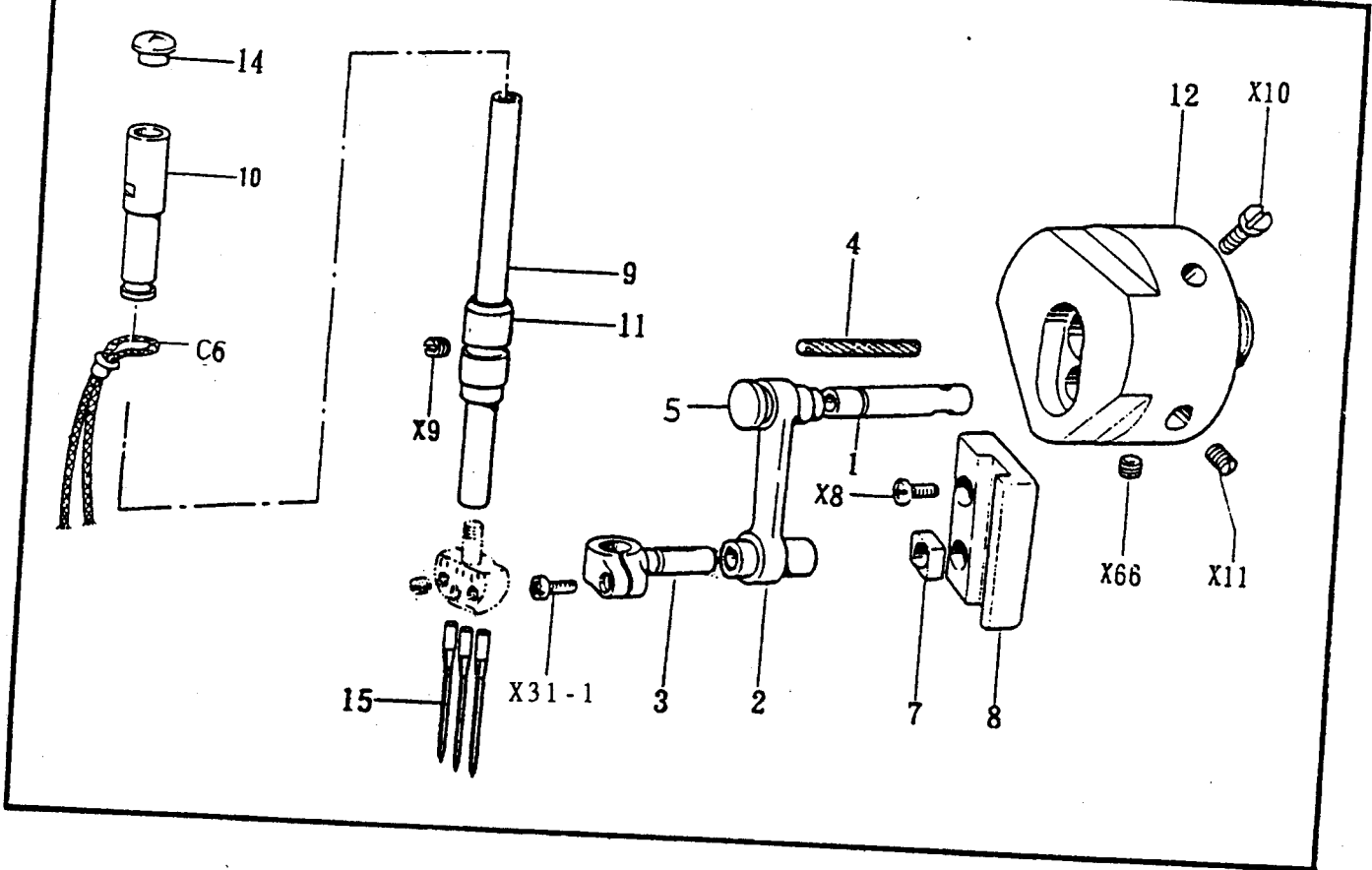

REF.NO.	NAME OF PARTS
C 2 - 1	NEEDLE BAR CRANK
C 2 - 2	NEEDLE BAR CRANK ROD
C 2 - 3	NEEDLE BAR BRACKET
C 2 - 4	WICK
C 2 - 5	OIL LEAK PROOF CAP
C 2 - C 6	WICK
C 2 - 7	NEEDLE BAR GUIDE SLIDE BLOCK
C 2 - 8	NEEDLE BAR GUIDE
C 2 - 9	NEEDLE BAR
C 2 - 1 0	NEEDLE BAR BUSHING (UPPER)
C 2 - 1 1	NEEDLE BAR BUSHING (LOWER)
C 2 - 1 2	THREAD TAKE-UP CRANK
C 2 - 1 4	OIL CAP
C 2 - 1 5	NEEDLE
C 2 - 1 6	FEED DOG ECCENTRIC AXLE
C 2 - 1 7	WASHER
C 2 - 1 8	ECCENTRIC WHEEL SLEEVE
C 2 - C19	ECCENTRIC WHEEL WITH SCREW
C 2 - 2 0	ECCENTRIC WHEEL SLEEVE
C 2 - C21	FEED BAR SLIDE BLOCK ASSEMBLY
C 2 - 2 2	PACKING
C 2 - 2 3	FEED LIFTING FORK
C 2 - 2 4	FEED BAR SLIDE BLOCK
C 2 - C25	FEED BAR ECCENTRIC SHAFT
C 2 - 2 6	FEED DOG ECCENTRIC SET
C 2 - X 7	SCREW 6.35
C 2 - X 8	SCREW 437*10
C 2 - X 9	SCREW 5.95
C 2 - X10	SCREW 5.95
C 2 - X11	SCREW 6.35
C 2 - X14	FEED ECCENTRIC ADJUSTING SCREW

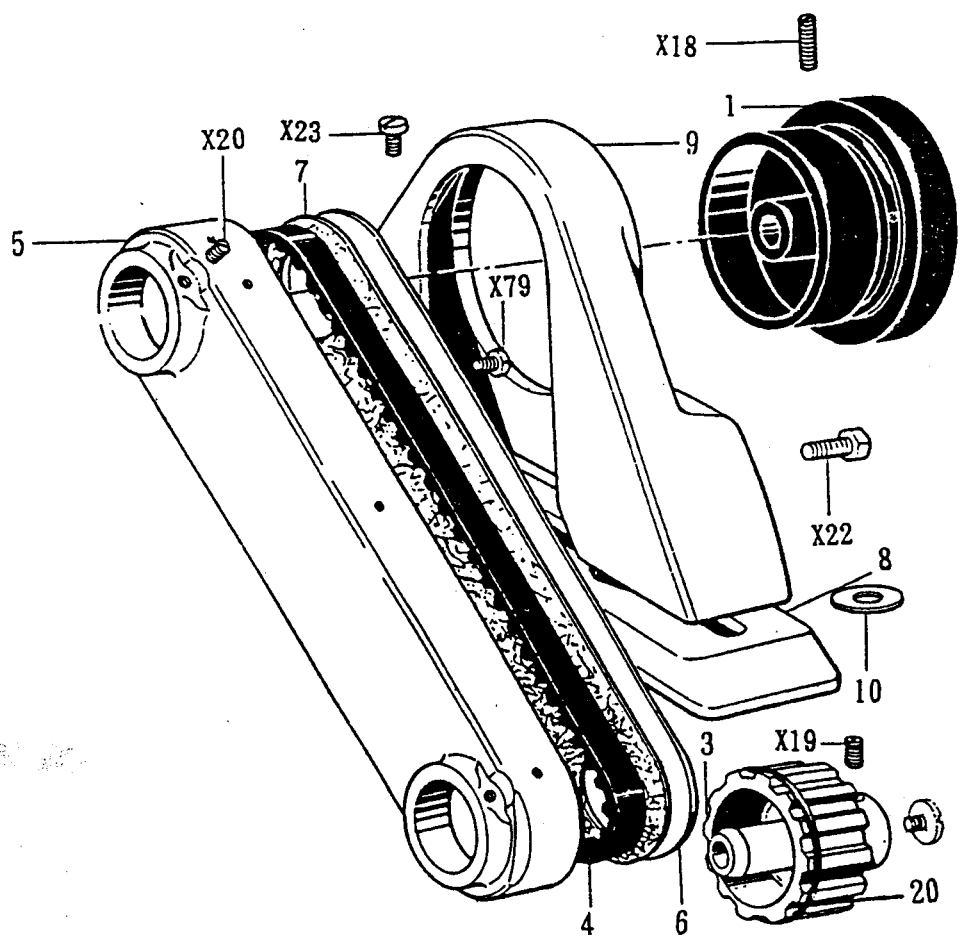
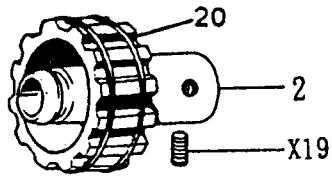

REF .NO.	NAME OF PARTS
C 3 - 1	PULLEY
C 3 - 2	TIMING BELT WHEEL ASSEMBLY (UPPER)
C 3 - 3	TIMING BELT WHEEL ASSEMBLY (LOWER)
C 3 - 4	TIMING BELT
C 3 - 5	BELT COVER
C 3 - 6	BELT COVER PLATE
C 3 - 7	PACKING
C 3 - 8	PULLEY COVER BASE
C 3 - 9	PULLEY COVER
C 3 - 1 0	WASHER
C 3 - 2 0	SPRING COIL
C 3 - X 1 8	SCREW 5.95
C 3 - X 1 9	SCREW 6.35*12
C 3 - X 2 0	SCREW 6.35
C 3 - X 2 2	SCREW 11.11
C 3 - X 2 3	SCREW 6.35
C 3 - X 7 9	SCREW 476*8

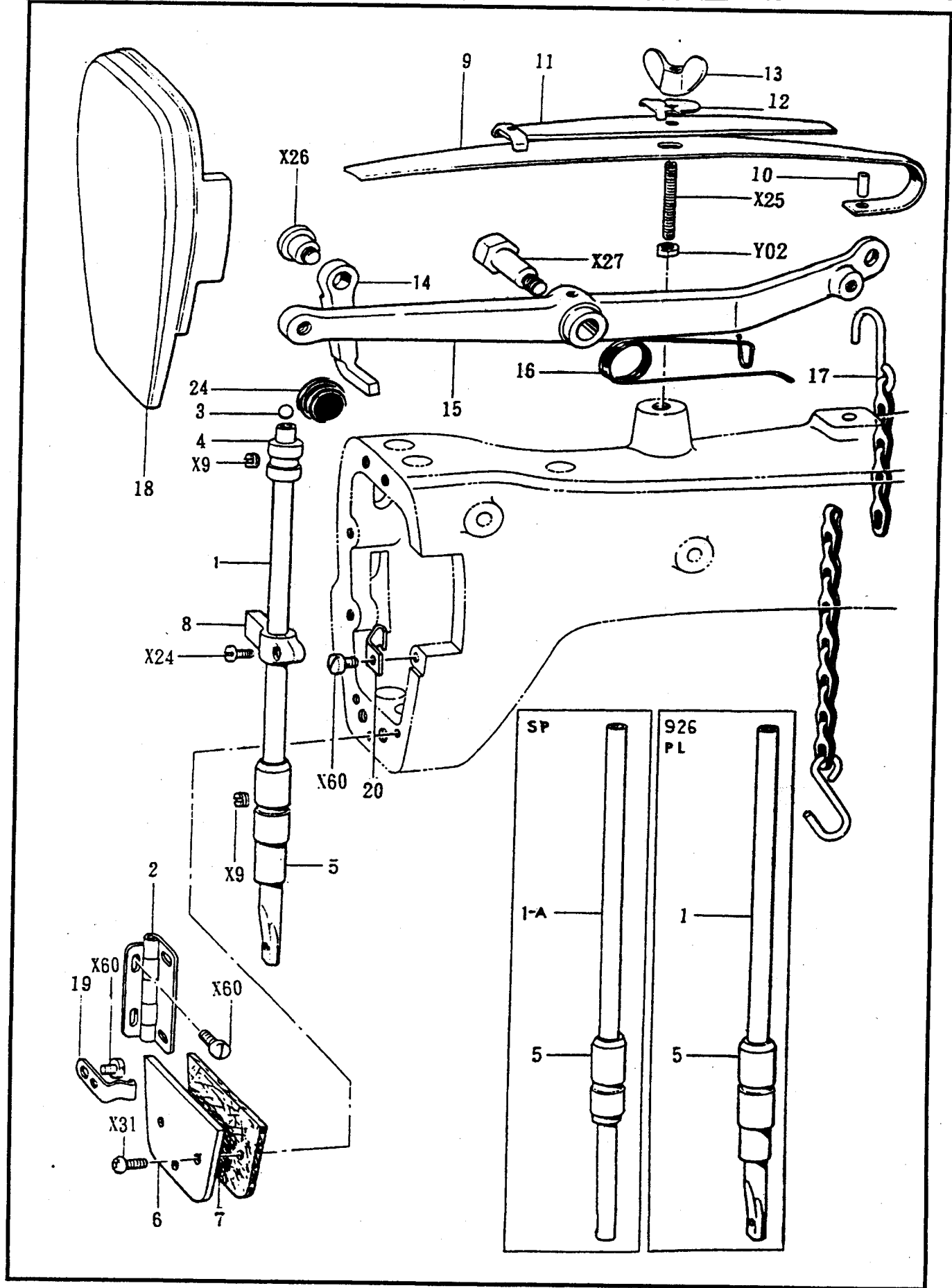

REF .NO.	NAME OF PARTS
C 4 - 1	PRESSER BAR
C 4 - 2	FACE PLATE UPPER HINGE ASSEMBLY
C 4 - 3	STEEL BALL
C 4 - 4	PRESSER BAR BUSHING (UPPER)
C 4 - 5	PRESSER BAR BUSHING (LOWER)
C 4 - 6	FACE PLATE (LOWER)
C 4 - 7	PACKING
C 4 - 8	PRESSER BAR CLAMP ASSEMBLY
C 4 - 9	PRESSER PLATE SPRING
C 4 - 10	PRESSER PLATE SPRING PIN
C 4 - 11	PRESSER PLATE SPRING ASSEMBLY
C 4 - 12	GUIDE WASHER
C 4 - 13	WING NUT
C 4 - 14	PRESSER BAR LIFTER
C 4 - 15	KNEE LIFTER LEVER
C 4 - 16	KNEE LIFTER SPRING
C 4 - 17	PRESSER FOOT LIFTER CHAIN ASSEMBLY
C 4 - 18	FACE PLATE (UPPER)
C 4 - 19	STOPPER SPRING PLATE (L)
C 4 - 20	STOPPER SPRING PLATE (S)
C 4 - 24	OIL CAP
C 4 - X 9	SCREW 5.95
C 4 - X 24	SCREW 4.37
C 4 - X 25	PRESSER ADJUSTING SCREW
C 4 - X 26	STUD SCREW 5.95
C 4 - X 27	STUD SCREW 7.94
C 4 - X 31	SCREW 357*10
C 4 - X 60	SCREW 3.75
C 4 - Y 02	NUT 4.76

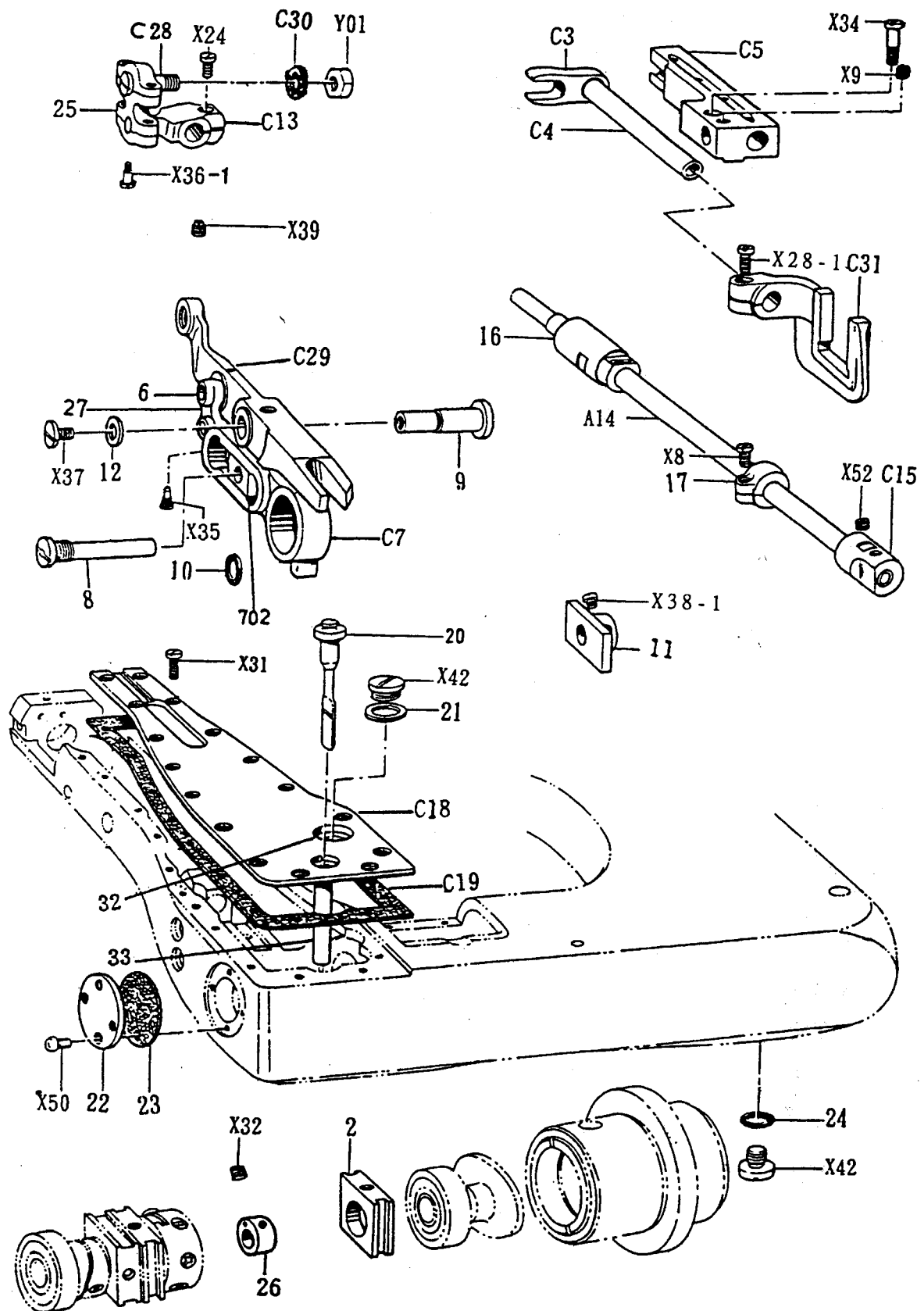

REF.NO.	NAME OF PARTS
C 5 - 2	ECCENTRIC WHEEL SLEEVE
C 5 - C 3	LOOPER FEEDING FORK
C 5 - C 4	LOOPER FEEDING SHAFT
C 5 - C 5	LOOPER FEEDING SHAFT BRACKET
C 5 - 6	PIN
C 5 - C 7	LOOPER FRONT-REAR TRANSMISSION
C 5 - 8	SLIDE BROCK SHAFT
C 5 - 9	LOOPER LEVER SHAFT
C 5 - 1 0	PACKING
C 5 - 1 1	CONNECTING ROD GUIDE PLATE
C 5 - 1 2	WASHER
C 5 - C13	LOOPER SHAFT CLAMP
C 5 - A14	LOOPER SHAFT
C 5 - C15	LOOPER SHAFT BUSHING (F)
C 5 - 1 6	LOOPER SHAFT BUSHING (B)
C 5 - 1 7	SET COLLAR
C 5 - C18	FORWARD ARM CONER ASSY
C 5 - C19	PACKING
C 5 - 2 0	OIL GAUGE
C 5 - 2 1	PACKING
C 5 - 2 2	CAP PLATE
C 5 - 2 3	PACKING
C 5 - 2 4	PACKING
C 5 - 2 5	"8" TYPE TRANSMISSION DEVICE
C 5 - 2 6	ECCENTRIC WITH SCREW
C 5 - 2 7	EYEPIECE
C 5 - C28	STEEL BALL
C 5 - C29	LOOPER SLIDE BASE
C 5 - C30	WASHER
C 5 - C31	LOOPER FEEDING FORK
C 5 - 3 2	-----

REF. NO.	NAME OF PARTS
C 5 - 3 3	-----
C 5 - 702	SQUARE BALL
C 5 - X 8	SCREW 437*7
C 5 - X 9	SCREW 5.95
C 5 - X24	SCREW 4.37
C 5 - X28-1	SCREW 4.37
C 5 - X31	SCREW 3.57
C 5 - X32	SCREW 4.37
C 5 - X34	SCREW 4.76
C 5 - X35	SCREW 2.38
C 5 - X36-1	SCREW M3.5*10
C 5 - X37	SCREW 4.37
C 5 - X38-1	SCREW 4.37
C 5 - X39	SCREW 5.95
C 5 - X42	SCREW 12.70
C 5 - X50	SCREW 357*5
C 5 - X52	SCREW 5.95
C 5 - Y01	NUT 5.95

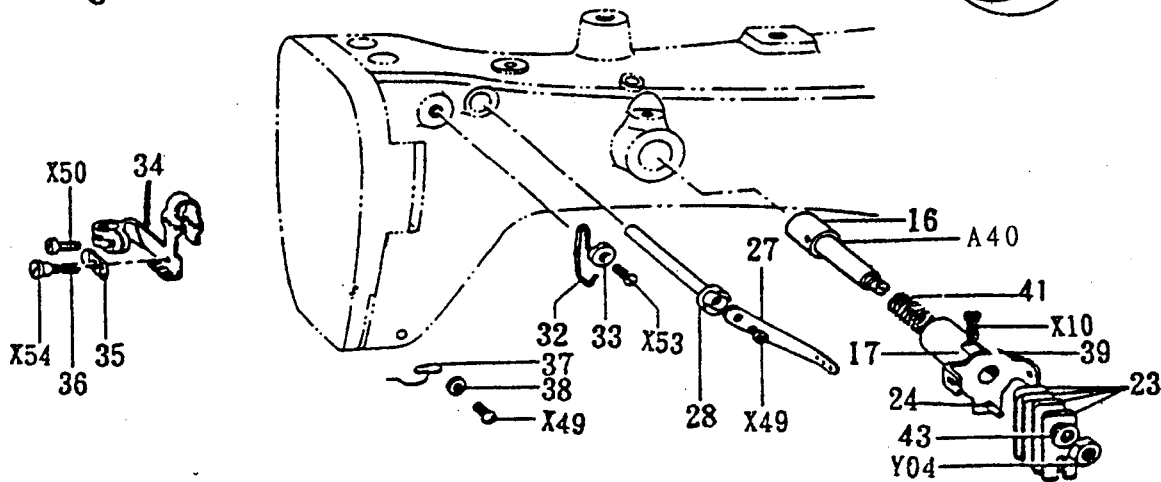
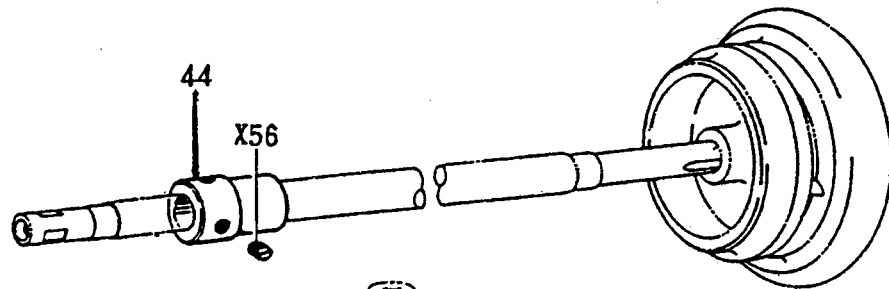
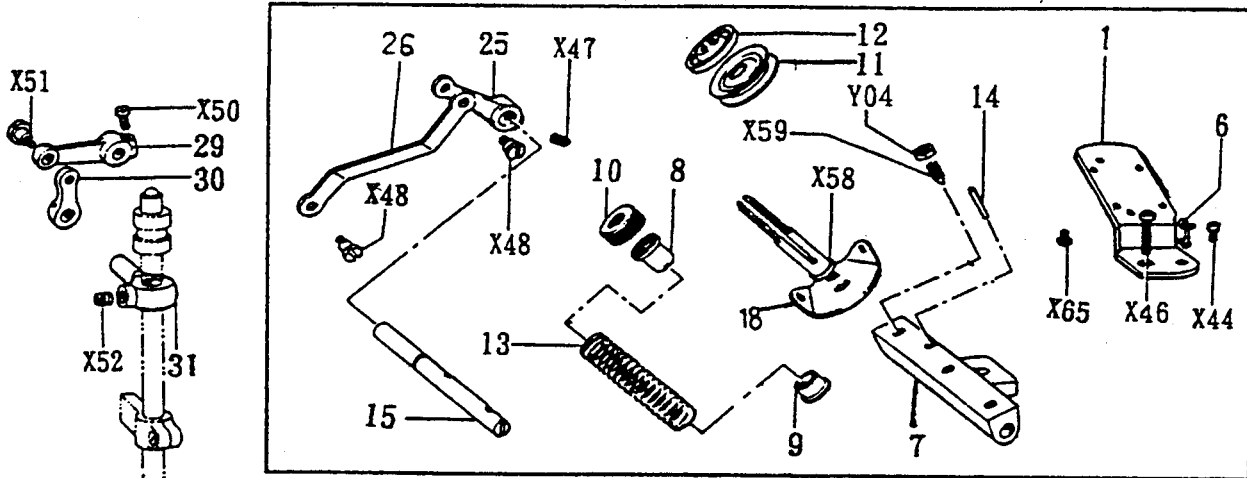
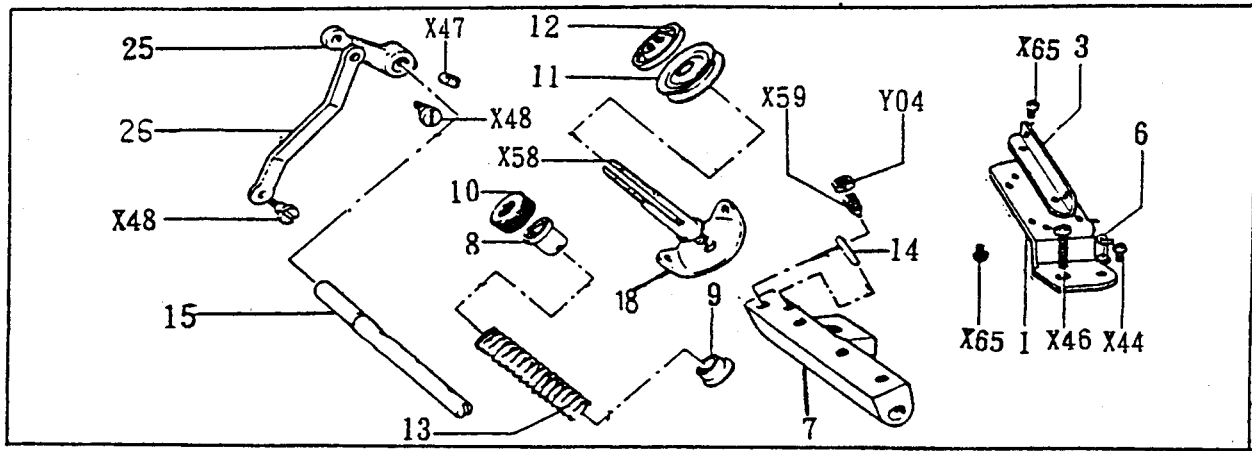

REF .NO.	NAME OF PARTS
C 6 - 1	UPPER THREAD GUIDE RETAINER
C 6 - 3	BRACKET
C 6 - 6	THREAD HANGER
C 6 - 7	LINE GUIDE DEVICE
C 6 - 8	TENSION SPRING WASHER
C 6 - 9	TENDION SPRING WASHER
C 6 - 10	UPPER THREAD TENSION ADJUSTING NUT
C 6 - 11	TENSION DISC
C 6 - 12	TENSION DISC PRESSER
C 6 - 13	UPPER THREAD TENSION SPRING
C 6 - 14	UPPER THREAD RELEASE PIN
C 6 - 15	THREAD RELEASER SHAFT
C 6 - 16	-----
C 6 - 17	-----
C 6 - 18	UPPER THREAD TENSION SUTD SCREW
C 6 - 23	LOWER THREAD TENSION PLATE
C 6 - 24	PIN
C 6 - 25	TENSION RELEASE CRANK
C 6 - 26	TENSION RELEASE CONNECTING BAR
C 6 - 27	THREAD RELEASER LEVER
C 6 - 28	THREAD RELEASER LEVER SHAFT
C 6 - 29	TENSION RELEASE CONNECTING ROD
C 6 - 30	TENSION RELEASE LINK
C 6 - 31	TENSION RELEASE SUTD
C 6 - 32	THREAD GUIDE
C 6 - 33	WASHER
C 6 - 34	UPPER THREAD TAKE-UP LEEVER ASSEMBLY
C 6 - 35	THREAD CHECKER
C 6 - 36	SPRING
C 6 - 37	LOEWR THREAD GUIDE
C 6 - 38	WASHER

REF.NO.	NAME OF PARTS
C 6 - 3 9	UPPER THREAD TENSION REGULATOR ASSEMBLY
C 6 - A40	UPPER THREAD TENSION SUTD ASSEMBLY
C 6 - 4 1	UPPER THREAD TENSION SPRING
C 6 - 4 3	WASHER
C 6 - 4 4	UPPER THREAD FASTENING CAM WITH SCREW
C 6 - X10	SCREW 5.95
C 6 - X44	SCREW 357*5
C 6 - X46	SCREW 476*20
C 6 - X47	SCREW 4.37
C 6 - X48	SCREW 3.57
C 6 - X49	SCREW 357*6
C 6 - X50	SCREW 3.57
C 6 - X51	SCREW 4.76
C 6 - X52	SCREW 5.95*6
C 6 - X53	SCREW 3.57
C 6 - X54	SCREW 2.38
C 6 - X56	SCREW 5.95
C 6 - X58	UPPER THREAD TENSION STUD SCREW
C 6 - X59	SCREW 4.37
C 6 - X65	SCREW 238*4
C 6 - Y04	NUT 4.37

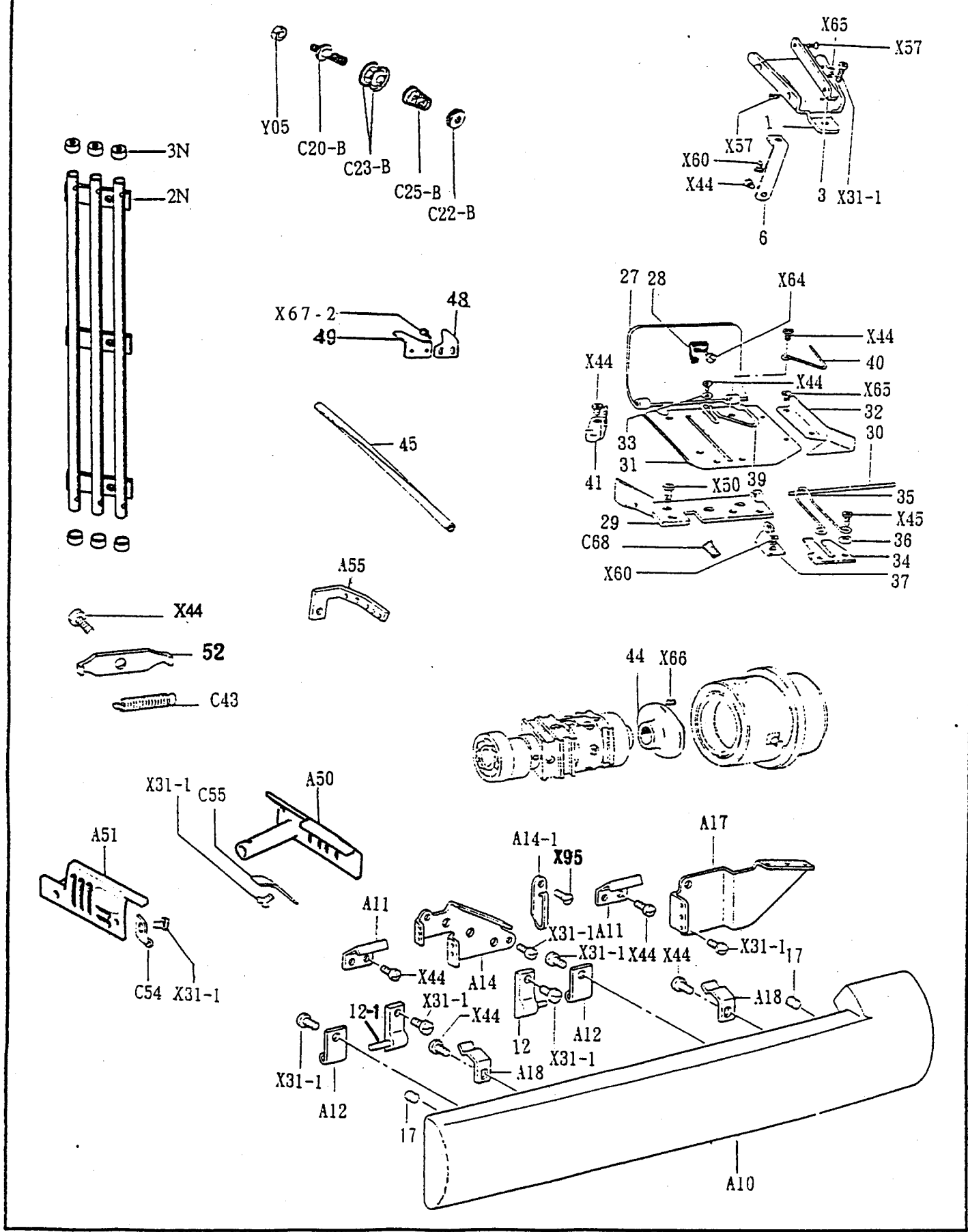

REF.NO.	NAME OF PARTS
C 7 - 1	LOWER THREAD GUIDE RETAINER
C 7 - 2N	THREE PIPE - LINE THREAD TUBE
C 7 - 3	BRACKET
C 7 - 3N	THREAD TUBE CLAMP
C 7 - 6	LOWER THREAD GUIDE SUPPORTER
C 7 - 7	FIXING PIN
C 7 - 1 2	LOWER THREAD GUIDE HINGE ASSEMBLY (L)
C 7 - 1 2-1	LOWER THREAD GUIDE HINGE ASSEMBLY (R)
C 7 - 1 7	PASTIC COVER
C 7 - A10	LOWER THREAD COVER
C 7 - A11	PLATE SPRING
C 7 - A12	FIXING PLATE
C 7 - A14	LOWER THREAD TENSION BRACKET
C 7 - A14-1	THREAD GUIDE
C 7 - A17	LOWER THREAD GUIDE RETAINER
C 7 - A18	PLATE SPRING
C 7 - A50	LOOPER SIDE COVER (R) ASSY
C 7 - A51	LOOPER SIDE COVER (L) ASSY
C 7 - A55	LOWER THREAD GUIDE
C 7 - C20-B	THREAD TENSION ROD
C 7 - C21-B	LOWER THREAD TENSION BRACKET
C 7 - C22-B	LOWER THREAD TENSION NUT
C 7 - C23-B	LOWER THREAD TENSION PLATE
C 7 - C25-B	LOWER THREAD TENSION SPRING
C 7 - C54	PLATE SPRING
C 7 - C55	PLATE SPRING
C 7 - 2 7	THREAD TAKE - UP LEVER COVER
C 7 - 2 8	SPRING
C 7 - 2 9	LOWER THREAD TAKE - UP LEVER FRAME

REF. NO.	NAME OF PARTS
C 7 - 3 0	LOWER THREAD TAKE - UP LEVER COVER SHAFT
C 7 - 3 1	LOWER THREAD TAKE - UP TEVER BASE
C 7 - 3 2	GUIDE PLATE
C 7 - 3 3	WASHER
C 7 - 3 4	LOWER THREAD GUIDE PLATE
C 7 - 3 5	SCREW
C 7 - 3 6	WASHER
C 7 - 3 7	LOWER THREAD GUIDE (LEFT)
C 7 - 3 9	LOWER THREAD GUIDE (RIGHT)
C 7 - 4 0	LOWER THREAD GUIDE (LEFT)
C 7 - 4 1	LOWER THREAD GUIDE PLATE
C 7 - 4 4	LOWER THREAD TAKE-UP DISC ASSEMBLY
C 7 - 4 5	LOWER THREAD FEED TUBE
C 7 - 4 8	THREAD CUTTER GUIDE PLATE
C 7 - 4 9	THREAD CUTTER
C 7 - 5 2	SPRING
C 7 - X31-1	SCREW 357*10
C 7 - X44	SCREW 357*5
C 7 - X45	SCREW 9/64*40
C 7 - X50	SCREW 3.57
C 7 - X57	SCREW 2.38
C 7 - X60	SCREW 357*4
C 7 - X64	SCREW 2.38
C 7 - X65	SCREW 238*4
C 7 - X66	SCREW 6.35
C 7 - X67-2	SCREW 238
C 7 - X68	SCREW 4.37
C 7 - X95	SCREW 3.57
C 7 - Y05	NUT 3.57

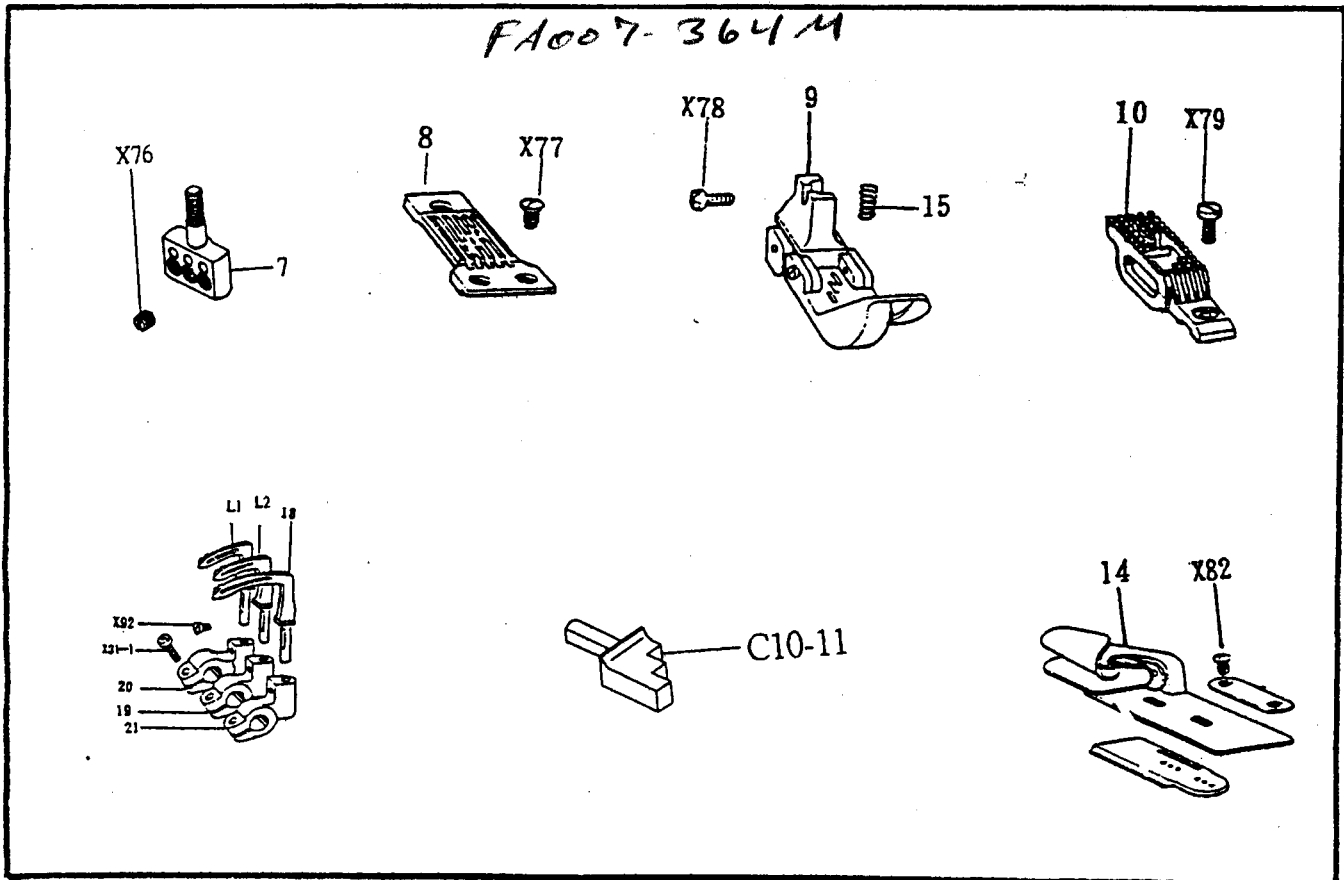
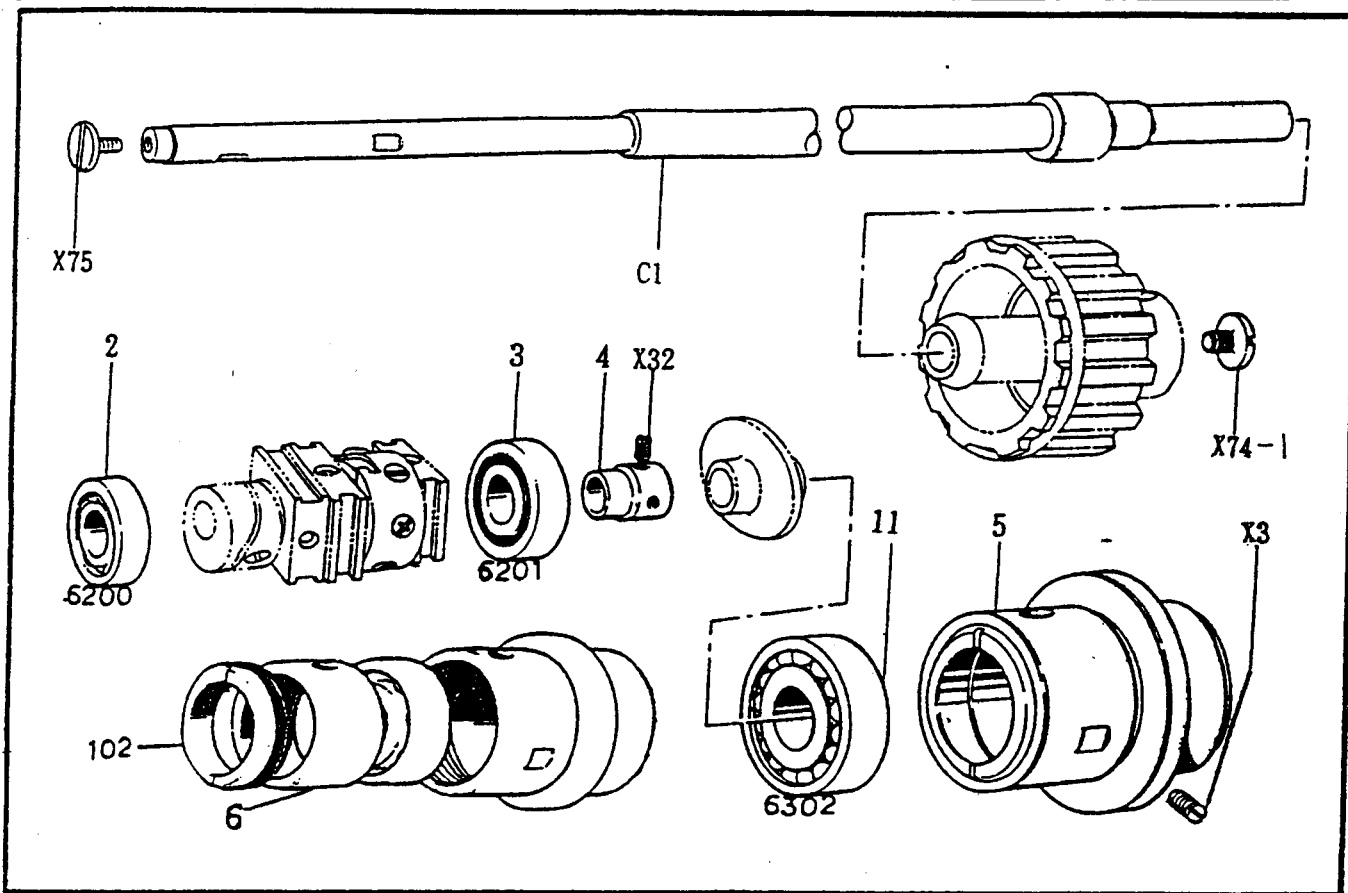

REF.NO.	NAME OF PARTS
C 8 - C1	LOVER SHAFT
C 8 - 2	BEARING 6200 Z
C 8 - 3	BEARING 6201 Z
C 8 - 4	BALL BEARING BUSHING
C 8 - 5	BEARING CASE ASSEMBLY
C 8 - 6	BEARING FIXING BUSHING
C 8 - 7	NEEDLE CLAMP WITH SCREW
C 8 - 8	NEEDLE PLATE
C 8 - 9	PRESSER FOOT ASSEMBLY
C 8 - 1 0	FEED DOG
C 8 - C10-11	NEEDLE GUARD
C 8 - 1 1	BEARING 6302
C 8 - 1 4	LAPPER ASSEMBLY
C 8 - 1 8	LOOPER LONG
C 8 - 1 9	LOOPER HOLDER (SHORT)
C 8 - 2 0	LOOPER HOLDER (MIDDLE)
C 8 - 2 1	LOOPER HOLDER (LONG)
C 8 - 102	BEARING FIXING SCREW
C 8 - L 1	LOOPER SHORT
C 8 - L 2	LOOPER MEDIUM
C 8 - X 3	SCREW 7.94
C 8 - X31-1	SCREW 357*10
C 8 - X32	SCREW 4.37
C 8 - X74-1	SCREW 6.35
C 8 - X75	SCREW 4.37
C 8 - X76	SCREW 4.37
C 8 - X77	SCREW 4.37
C 8 - X78	SCREW 3.57*8
C 8 - X79	SCREW 4.76
C 8 - X81	SCREW 3.57
C 8 - X82	SCREW 3.57
C 8 - X92	SCREW 3.57

SP

FA007-364 2L/SP

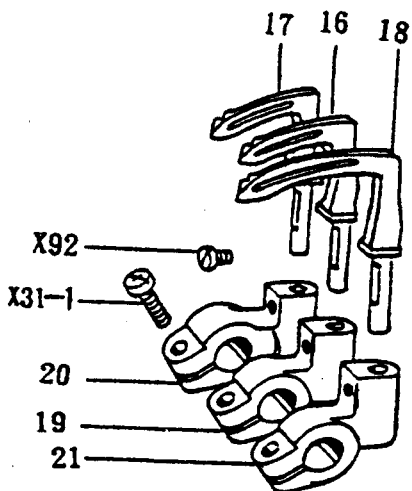
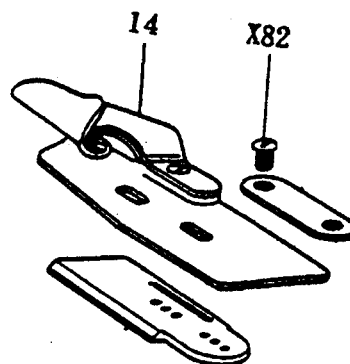
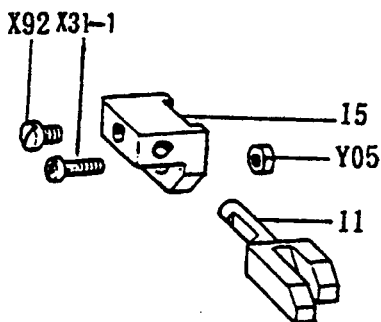
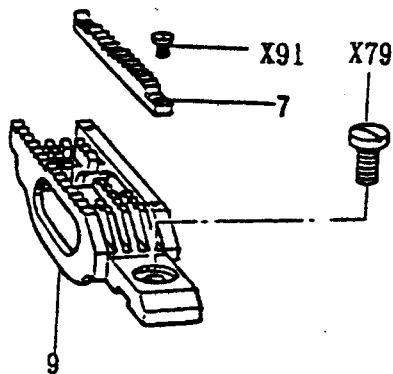
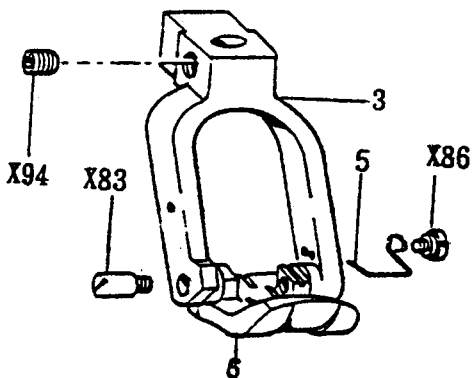
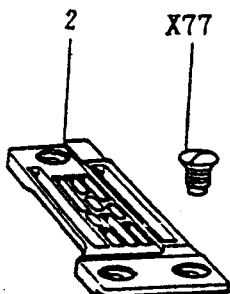
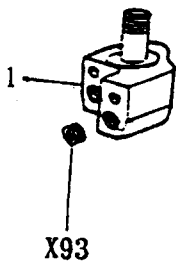

REF .NO.	NAME OF PARTS
C 9 - 1	NEEDLE CLAMP ASSEMBLY
C 9 - 2	NEEDLE PLATE
C 9 - 3	PRESSER FOOT ASSEMBLY
C 9 - 5	PRESSER FOOT (F) SPRING
C 9 - 6	PRESSER FOOT ASSEMBLY
C 9 - 7	SUB FEED DOG
C 9 - 9	FEED DOG
C 9 - 11	NEEDLE GUARD
C 9 - 14	LAPPER ASSEMBLY
C 9 - 15	NEEDLE GUARD BRACKET
C 9 - 16	LOOPER (SHORT)
C 9 - 17	LOOPER (MIDDLE)
C 9 - 18	LOOPER (LONG)
C 9 - 19	LOOPER HOLDER (SHORT)
C 9 - 20	LOOPER HOLDER (MIDDLE)
C 9 - 21	LOOPER HOLDER (LONG)
C9 - X31 - 1	SCREW 357*10
C 9 - X 7 7	SCREW 4.37
C 9 - X 7 9	SCREW 4.76
C 9 - X 8 2	SCREW 3.57
C 9 - X 8 3	PIN
C 9 - X 8 6	SCREW 2.38
C 9 - X 9 1	SCREW 1.98
C 9 - X 9 2	SCREW 3.57
C 9 - X 9 3	SCREW 3.18
C 9 - X 9 4	SCREW 5.95
C 9 - Y 0 5	NUT 3.57

DB

FA007-364/21/DB

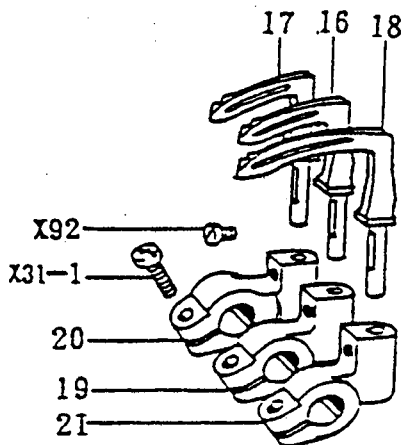
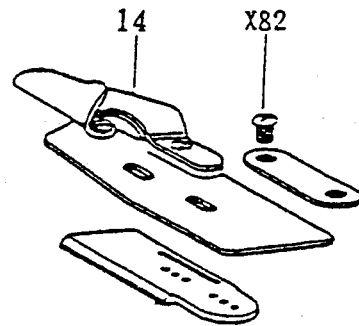
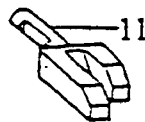
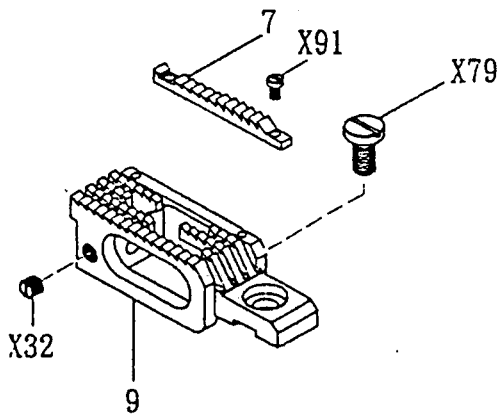
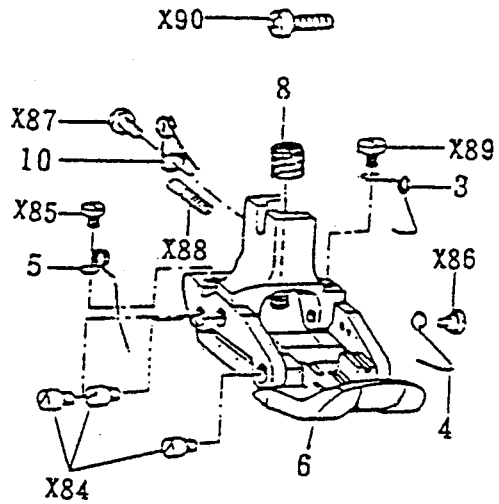
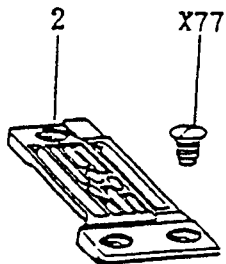
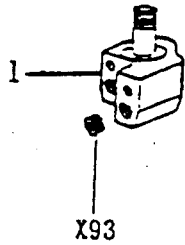

REF. NO.	NAME OF PARTS
C10 - 1	NEEDLE CLAMP ASSEMBLY
C10 - 2	NEEDLE PLATE
C10 - 3	SPRING M
C10 - 4	SPRING F
C10 - 5	SPRING BL
C10 - 6	PRESSER FOOT ASSEMBLY
C10 - 7	SUB FEED DOG
C10 - 8	NUT 3.18
C10 - 9	FEED DOG
C10 - 1 0	SPRING BS
C10 - 1 1	NEEDLE GUARD
C10 - 1 4	LAPPER ASSEMBLY
C10 - 1 6	LOOPER (SHORT)
C10 - 1 7	LOOPER (MIDDLE)
C10 - 1 8	LOOPER (LONG)
C10 - 1 9	LOOPER HOLDER (SHORT)
C10 - 2 0	LOOPER HOLDER (MIDDLE)
C10 - 2 1	LOOPER HOLDER (LONG)
C10 - X31-1	SCREW 357*10
C10 - X 3 2	SCREW 4.37
C10 - X 7 7	SCREW 4.37
C10 - X 7 9	SCREW 4.76
C10 - X 8 2	SCREW 3.57
C10 - X 8 4	STUD SCREW
C10 - X 8 5	SCREW 2.38*3.5
C10 - X 8 6	SCREW 2.38
C10 - X 8 7	SCREW 318*5
C10 - X 8 8	SCREW 3.18
C10 - X 8 9	SCREW 2.38
C10 - X 9 0	SCREW 3.57*8
C10 - X 9 1	SCREW 1.98

DP

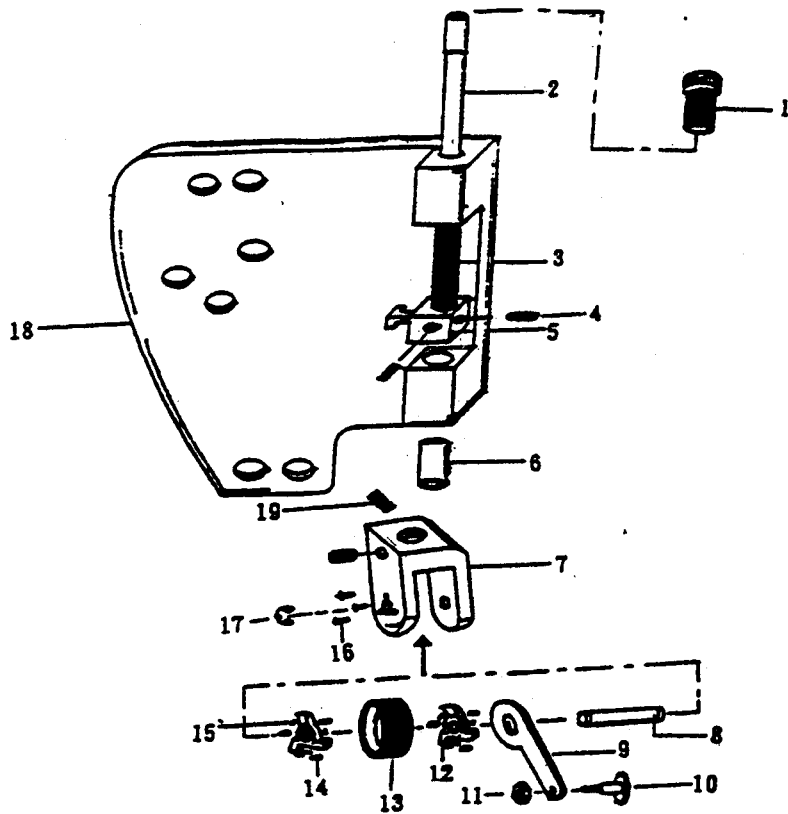

SP

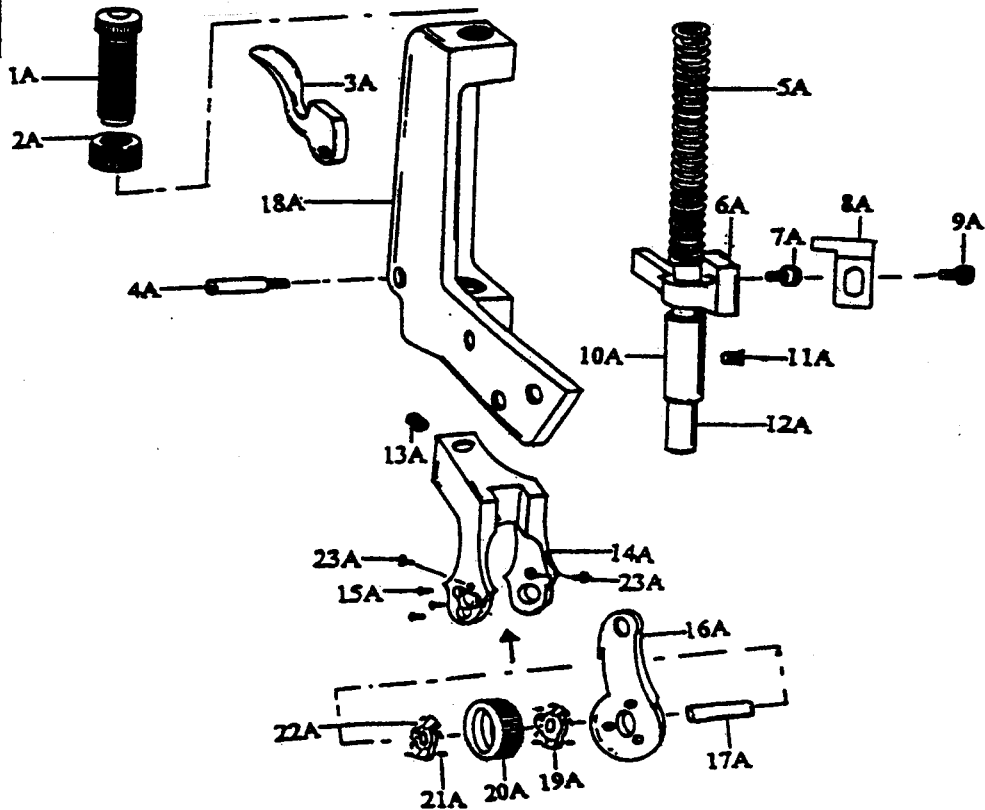

REF .NO.	NAME OF PARTS
C 1 1 - 1	PRESSURE ADJUSTING SCREW
C 1 1 - 2	UPPER WHEEL PRESSER BAR
C 1 1 - 3	SPRING
C 1 1 - 4	FIXING DEVICE SCREW
C 1 1 - 5	WHEEL DIRECTION FIXING DEVICE
C 1 1 - 6	PRESSER ROD BUSHING
C 1 1 - 7	UPPER WHEEL SEAT
C 1 1 - 8	UPPER WHEEL CONNECTON
C 1 1 - 9	ONE WAY PULL HOLDER
C 1 1 - 1 0	SCREW
C 1 1 - 1 1	NUT
C 1 1 - 1 2	ONE WAY TRIANGULAR WHEEL
C 1 1 - 1 3	UPPER WHEEL
C 1 1 - 1 4	ONE WAY STILL BALL
C 1 1 - 1 5	ONE WAY STILL SPRING
C 1 1 - 1 6	TRIANGULAR AXLE FIXING SCREW
C 1 1 - 1 7	CHOCK RING
C 1 1 - 1 8	FACE PLATE (UPPER)
C 1 1 - 1 9	SCREW
C 1 1 - 1 A	PRESSURE ADJUSTING SCREW
C 1 1 - 2 A	NUT
C 1 1 - 3 A	PRESSER FOOT LIFTER
C 1 1 - 4 A	STUD SCREW
C 1 1 - 5 A	SPRING
C 1 1 - 6 A	PRESSER BAR GUIDE ASSEMBLY
C 1 1 - 7 A	SCREW
C 1 1 - 8 A	ROLLER PRESSER BAR LIFTER
C 1 1 - 9 A	SCREW
C 1 1 - 1 0 A	PRESSER ROD BUSHING
C 1 1 - 1 2 A	UPPER WHEEL PRESSER BAR

REF .NO.	NAME OF PARTS
C11 - 13A	SCREW
C11 - 14A	PULLER SUPPORTER ASSEMBLY
C11 - 15A	SCREW
C11 - 16A	ONE WAY PULL HOLDER
C11 - 17A	UPPER WHEEL CONNECTON
C11 - 18A	FACE PLATE
C11 - 19A	ONE WAY TRIANGULAR WHEEL
C11 - 20A	UPPER WHEEL
C11 - 21A	ONE WAY STILL BALL
C11 - 22A	ONE WAY STILL SPRING
C11 - 23A	SCREW

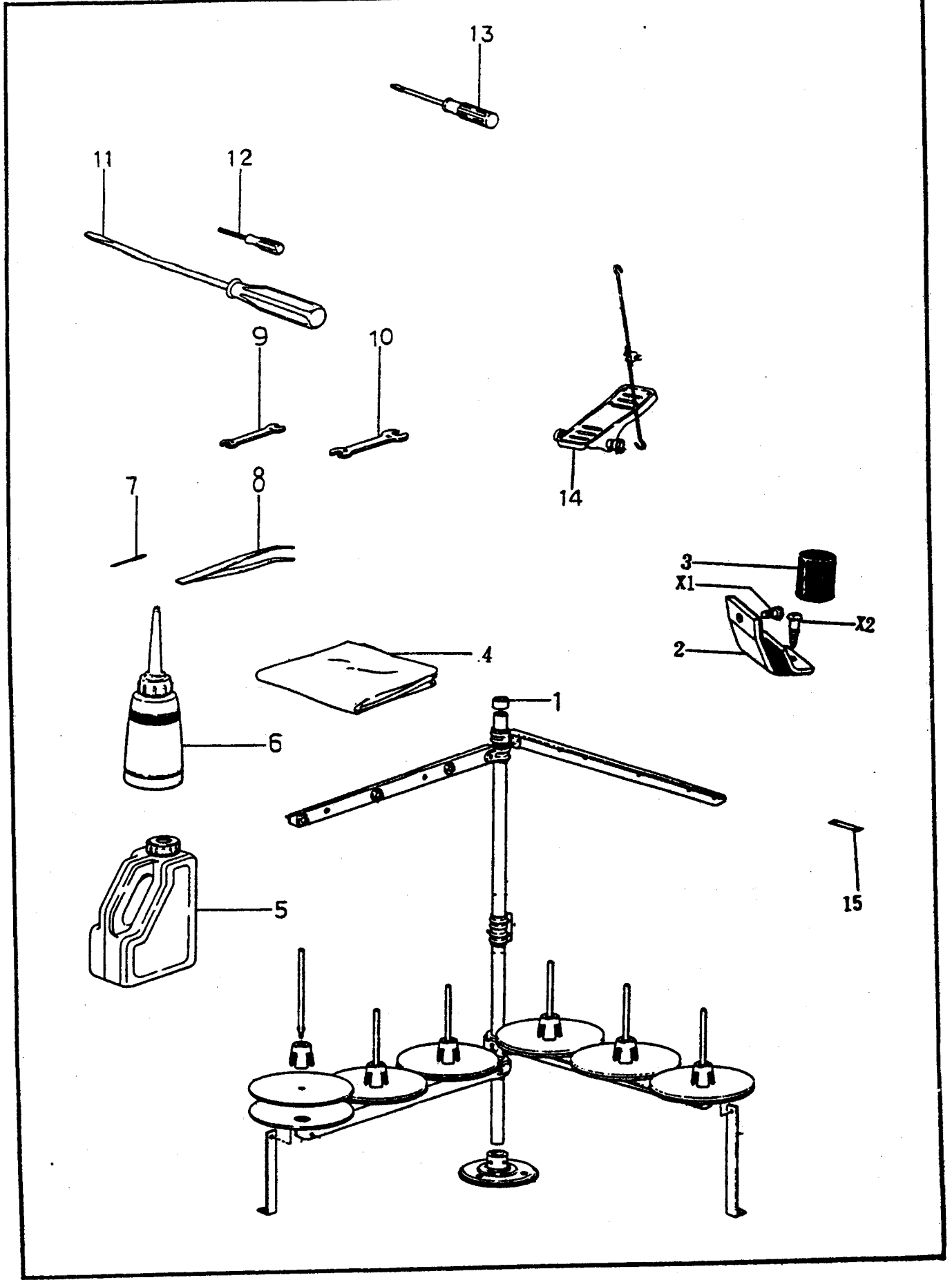

REF .NO.	NAME OF PARTS
C12 - 1	THREAD STAND
C12 - 2	CUSHION ASSEMBLY
C12 - 3	BASE CUSHION
C12 - 4	HEAD COVER
C12 - 5	OIL TANK
C12 - 6	OILER ASSEMBLY
C12 - 7	NEEDLE
C12 - 8	TWEEZERS
C12 - 9	SPANNER
C12 - 10	SPANNER
C12 - 11	SCREW DRIVER
C12 - 12	SCREW DRIVER
C12 - 13	SCREW DRIVER
C12 - 14	THREADLE
C12 - 15	SPACER < THREAD TRIMMER >
C12 - X1	SCREW 6.35
C12 - X2	SCREW 6.2*26
C12 - X22	SCREW 11.11
C12 - X23	SCREW 6.35



FA007

FA007